

FORD MOBILE CHARGER

The Ford Mobile Charger can use either a:

1. Standard home 120V outlet (3 miles of range per charging hour)* OR
2. 240V NEMA 14-50 outlet (20 miles of range per charging hour)* to be installed by a licensed electrician

EQUIPMENT INCLUDED WITH VEHICLE PURCHASE:



NEMA 14-50 OUTLET DETAILS

- CIRCUIT BREAKER
50A – GFCI Recommended
- VOLTAGE
240 VAC nominal, 2 poles, 60 Hz
- FOUR WIRE CONFIGURATIONS
L1, L2, Ground and Neutral
- OUTLET
NEMA 14-50 (recommend industrial-grade outlet, if plan to plug/unplug often)
- CONDUCTORS
Follow local and national codes/regulations.
- GROUND PIN ORIENTATION
Top position of outlet.
- VENTILATION
Not required.
- OUTLET INSTALLATION HEIGHT
Between 35" and 60" from ground to outlet.
- DIMENSIONS
126mm X 259mm x 59mm (WxHxD).

HOW TO CHARGE

1. Install the Ford Mobile Charger bracket near the 120V or 240V outlet.
2. Attach the 120V or 240V connector to the mobile charger.
3. Plug the mobile charger connector into the 120V or 240V outlet.
4. Clip the mobile charger into the wall-mounted bracket.
5. Plug the mobile charger cord set coupler into the vehicle charge port.
6. The vehicle will begin to charge (unless outside of pre-scheduled charge times).

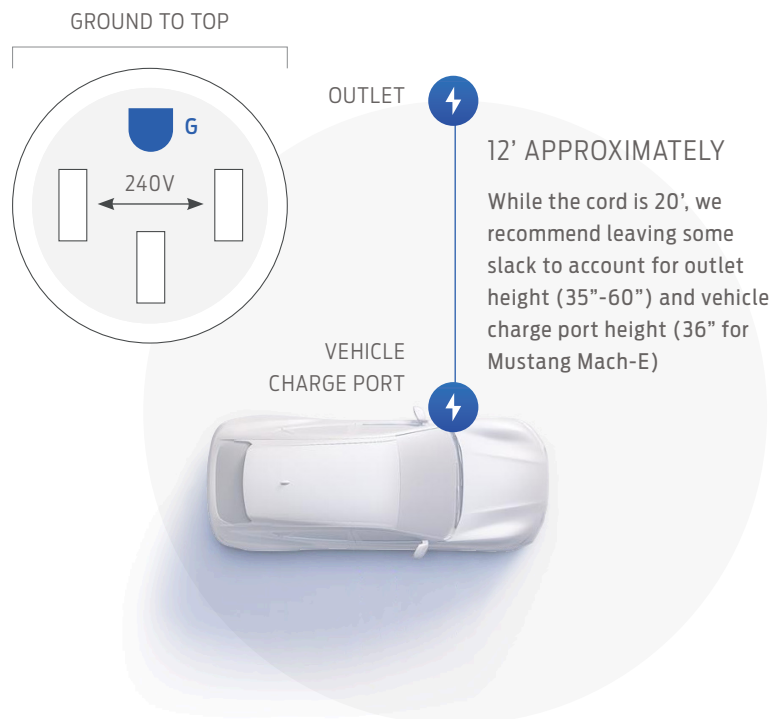

OTHER RESOURCES

How-To Videos

Charging Basics: <http://ford.to/chargingbasics>

Charging at Home: <http://ford.to/chargingathome>

Questions/Assistance?

Ford Customer Relationship Center:

1-800-392-FORD (3673)



*Range and charge time based on manufacturer computer engineering simulations and EPA-estimated range calculation methodology. The charging rate decreases as battery reaches full capacity. Your results may vary based on peak charging times and battery state of charge. Actual vehicle range varies with conditions such as external elements, driving behaviors, vehicle maintenance, lithium-ion battery age and state of health.